

## EnduraTouch™ FX PC Workstations (NEMA 4/4X)

### Product Features

- NEMA 4X Enclosure
- 15 or 17" Front Access Active Matrix LCD
- Resistive Touchscreen Option
- Stainless Steel Construction
- M Series Processing - up to 1.8 GHz with up to 1 GB of memory
- ATOM Dual Core Processing - Up to 1.6 GHz with up to 2 GB of memory
- Optional ACP ThinManager Enabled
- (1) PCI card slot
- Windows: XP Pro, Vista, XP Embedded or Linux
- VESA 100mm mounting pattern
- Sealed I/O Ports
- Wireless Option



**EnduraTouch FX Computers**  
Optional keyboards shown on all models. Front access model allows quick, easy access to internal components.

### Specifications

		15" Diagonal - ET 1500 FX	17" Diagonal - ET 1700 FX
<b>LCD Display</b>			
Panel Type		TFT Active Matrix	TFT Active Matrix
Maximum Resolution		1024 x 768	1280 x 1024
Brightness		250 cd/m <sup>2</sup>	300 cd/m <sup>2</sup>
Viewing Angle		H ±70, V ±70	H ±80, V ±80
Light Source		(2) CCFL 40,000 Hours	(4) CCFL 50,000 Hours
Colors		16.7 Million	16.7 Million
Contrast Ratio		550:1	1000:1
Touchscreen		Resistive, Antiglare	Resistive, Antiglare
<b>Mechanical</b>			
Size (W x H x D)	inch	16" x 13.3" x 6"	16" x 13.3" x 6"
	mm	406 x 338 x 152	406 x 338 x 152
Weight		27 lbs., (12.2 kg.)	30 lbs., (13.6 kg.)
Material		Stainless Steel 304	Stainless Steel 304
Finish		No. 4, Polished	No. 4, Polished
Rating		NEMA 4X (IP65)	NEMA 4X (IP65)
Humidity		10% - 90% RH	10% - 90% RH
Temperature	operating	0 - 50°C	0 - 40°C
	storage	-20°C to +60°C	-20°C to +60°C
<b>Electrical</b>			
Voltage		85 - 264VAC, 9 - 36 VDC (optional)	85 - 264VAC, 9 - 36 VDC (optional)
Current		0.32, max. @ 115 VAC 3.0A @ 12VDC (optional)	0.42, max. @ 115 VAC 4.0A @ 12VDC (optional)
Power Consumption		36 Watts, Pentium M	48 Watts, Pentium M
<b>Processors</b>			
<b>Interface</b>		<b>Pentium M</b>	<b>ATOM</b>
I/O Ports		(2) USB, (4) COM, (1) VGA, (1) Digital IO, (2) LAN, PWR	(8) USB, (1) COM, (1) LAN, (1) Parallel Port, PWR
<b>Processor</b>			
CPU		1.8 GHz Pentium M Series	1.6 GHz Dual Core ATOM Processor
Slots		(1) PCI optional	(1) PCI optional
Operating System		ACP ThinManager Enabled, Windows XP Pro, Vista, XP Embedded, Linux	ACP ThinManager Enabled, Windows XP Pro, Vista, XP Embedded, Linux
Memory		Up to 1 GB DDR RAM	Up to 2 GB DDR RAM
Video		Integrated Controller	Integrated Controller
Sound		Integrated AC97 Audio	Integrated Audio - ALC-662
LAN		(1) 10/100BT (1) Gbit Enet	10/100/1000
<b>Peripherals</b>			
2.5" IDE Hard Drive		80 GB	160 GB
CF Drive		Up to 32 GB UDMA (1) CFD	---
Other	optional	Internal USB wireless LAN adapter with removable antenna	Internal USB wireless LAN adapter with removable antenna

**COMARK CORPORATION**

**Engineered Solutions**

[www.comarkcorp.com](http://www.comarkcorp.com)

**1-800-280-8522**

## Dimensional Drawing

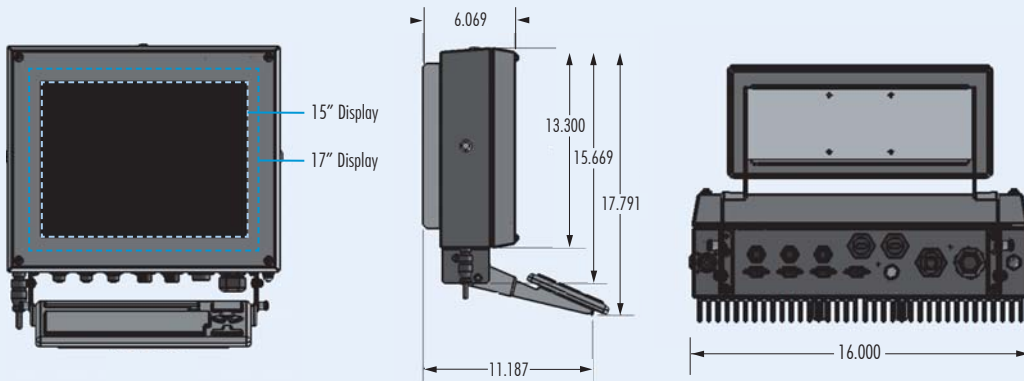

## Wall Mount Information

### VESA Mounting Pattern

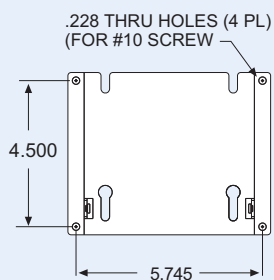

### Wall Mount Template

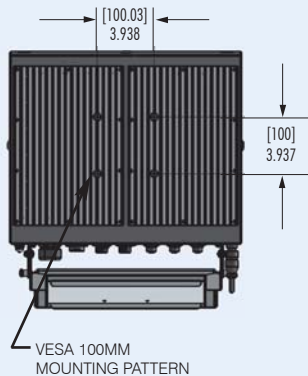

## View of Options

- A. Wall Mount Bracket
- B. Keyboard and Tray Assembly
- C. Pedestal Stand

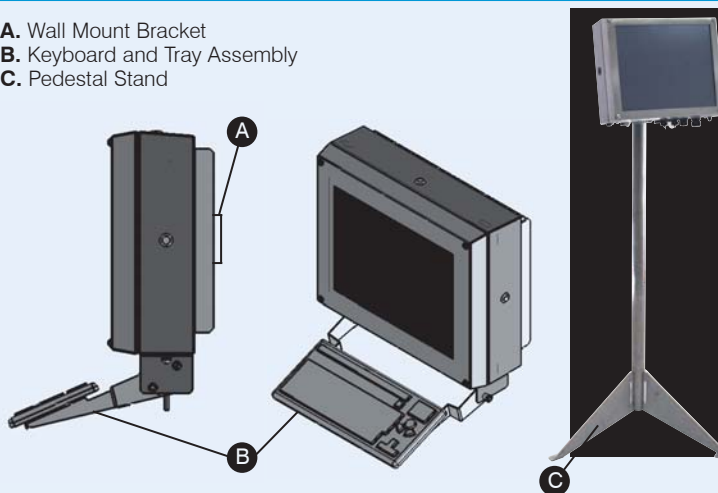

## Interface Information

